

CE	SALTO SYSTEMS, S.L.
	Pol. Indust. Las Barreras, c/Arkatuz, 9 20180, Guecho - Guipuzkoa, Spain
	08
EN 1792003VC1	3 7 6 1 1 3 3 2 A

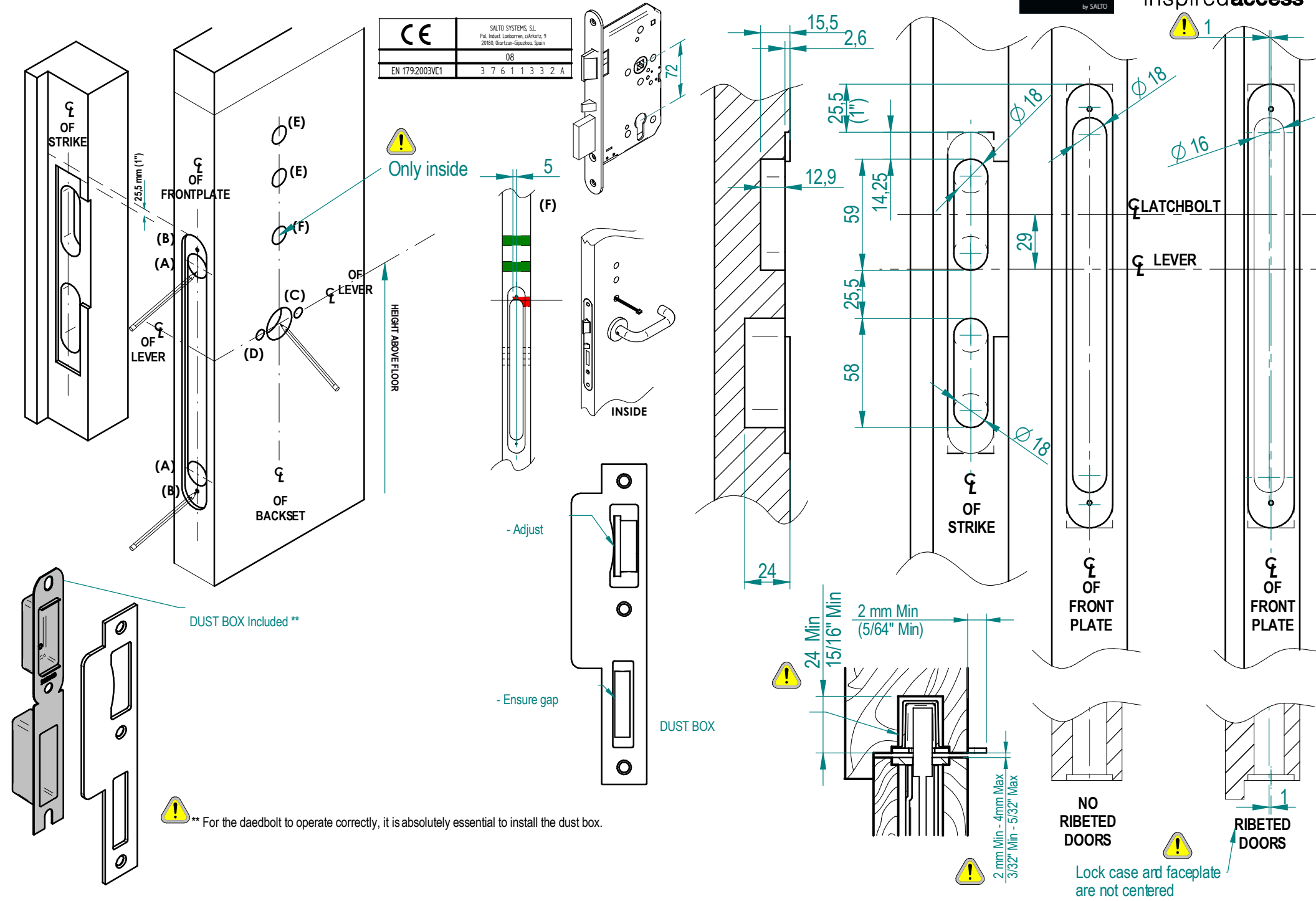

LOCK AND STRIKE INSTALATION

(Eng)

- PREPARING THE DOOR**
1. Draw a horizontal line on edge of the door and on **inside** at the desired height of knob above floor.
 2. Draw a vertical centre line on door edge.
 3. Draw a vertical line on **inside** at the proper **backset** to align the template.
 4. Position template on edge of door. Mark **ONLY** top and bottom holes of mortise cavity (A) and lock front (B) on door edge. Remove template. Place lock face against door edge. Trace outline of faceplate as guide for faceplate routing.
 5. Mortise door for lock body and faceplate as per instructions on template
 6. Position template on **inside** of door. Mark holes in the lateral face of the door for handles (C and D). Mark the corresponding holes for the electronic escutcheon fixings (E and F). **The (F) hole doesn't have to be through, its depth has to be 5mm longer than the lock center.**
- INSTALLING THE LOCK BODY**
1. Insert wires through (F) hole.
 2. Insert the lock into the cavity.
 3. Mark & drill faceplate holes. Fasten with faceplate screws to hold lock in place.
- INSTALLING THE STRIKE**
1. Center strike to lock's frontplate center lane. Refer to latch to determine strike location on jamb.
 2. Using strike as template, mark and chisel recess. Drill holes for dust box. Place dust box and strike and fasten screws.
- Please check that:**
- Deadbolt and latch fit the cavities of the strike **without touching it.**
 - Gap between door and jamb is between 2-4 mm.
 - Strike flap should protrude a minimum 2mm, if it does not, please ask your distributor for the availability of special strikes.

LUBRICATION

All locks come from the factory pre-lubricated with grease. We recommend, however, continued periodic lubrication of moving parts with commercial quality grease (every 20.000 cycles or once a year), from outside the lock. This can prolong the life of the lockset by reducing excessive wear. If the lockset is used in a harsh environment, lubrication should be applied more frequently.

Dimension in millimetres (dimensi on in inches)

All contents current at time of publication. SALTO Systems S.L. reserves the right to change availability of any item in this catalogue, its design, construction, and/or materials.

DOOR INSIDE

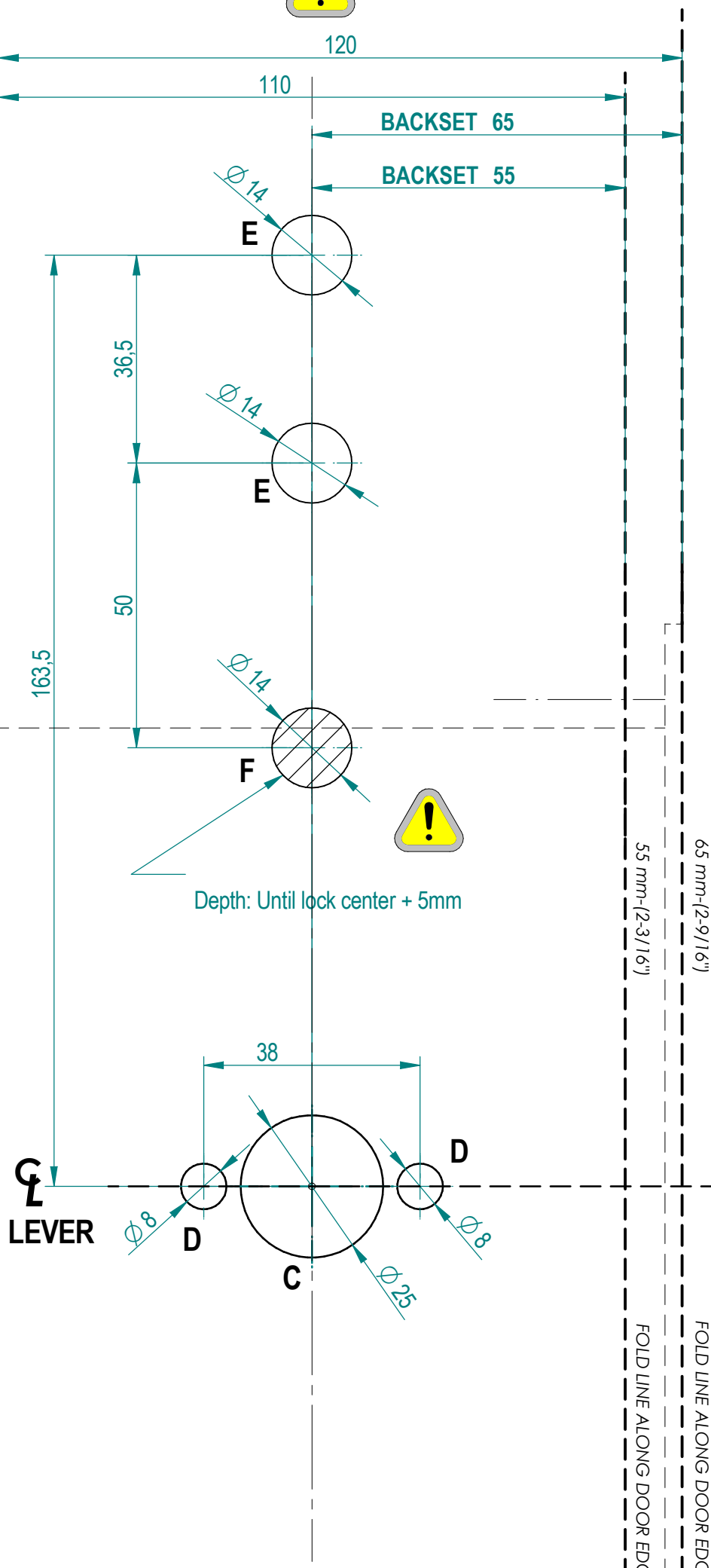

Through holes except from the indicated

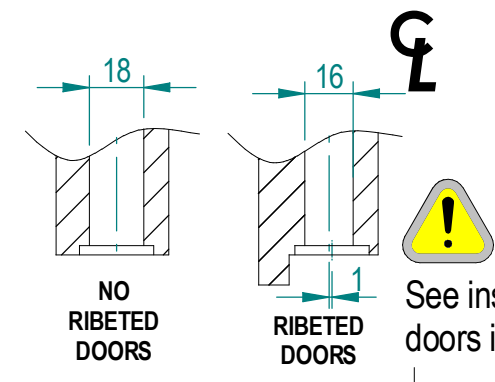

Vertical center line of Lock Front Plate



Depth: Until lock center + 5mm

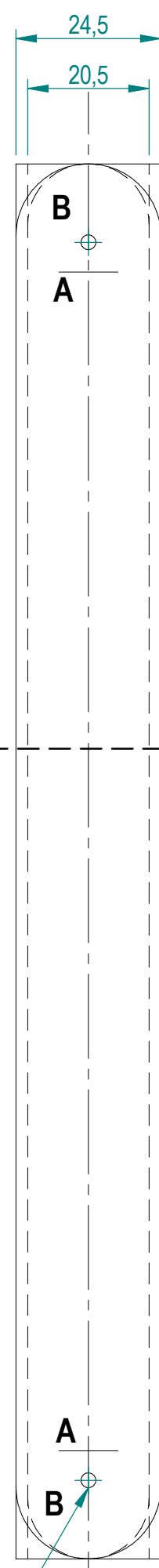

Ø 2,5 PROF. 30mm



DOOR INSIDE

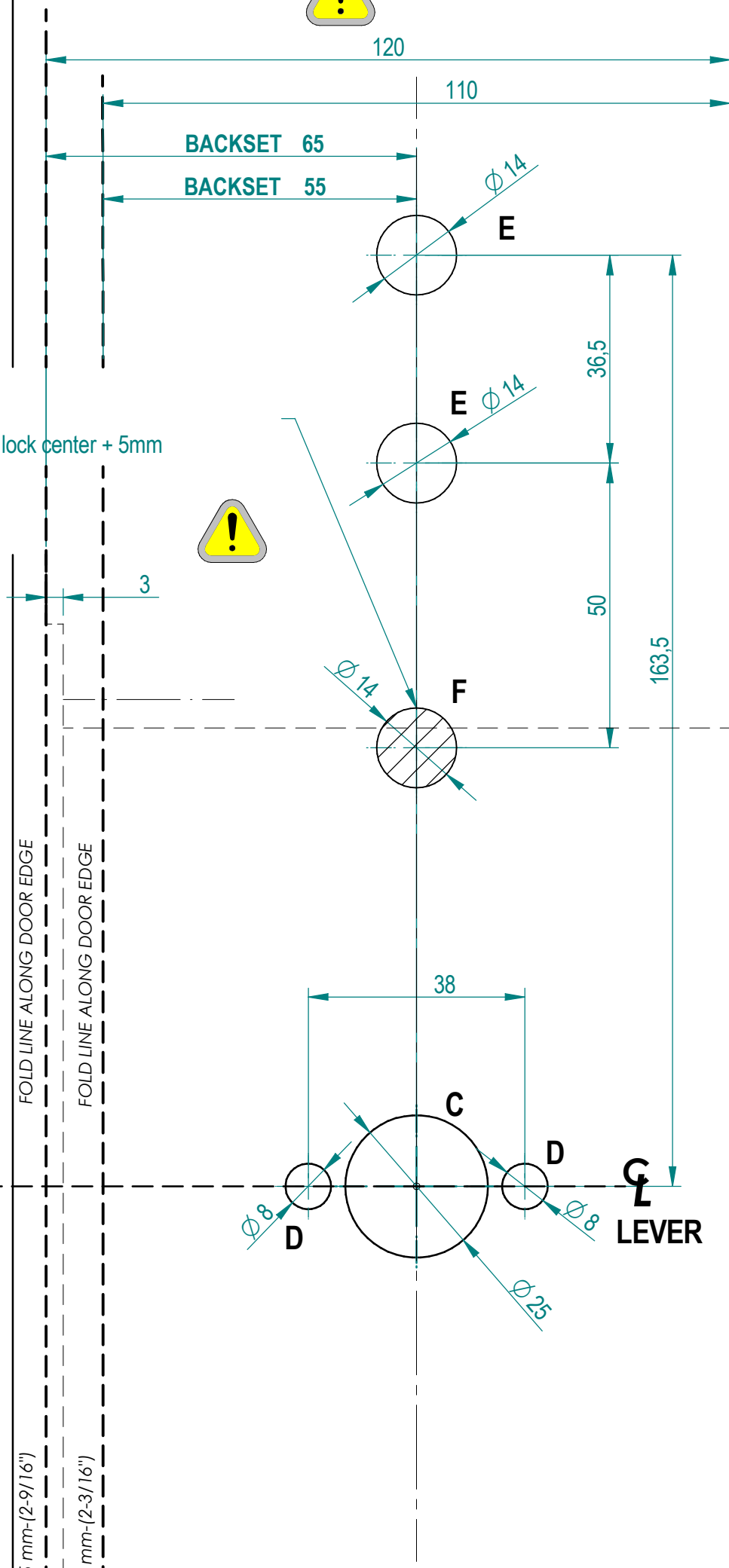

Through holes except from the indicated

